

GUIDE TO FINDING OUR SCHOOLS/CLASS LOCATIONS

ADMINISTRATION BUILDING/ENRICHMENT OFFICE

The Administration building is located at 8107 Mustang Drive. Mustang Drive is east of S. Westnedge near the Dairy Queen on Centre. Turn onto Mustang Drive and the building will be on your left. Please use the main entrance.

COMMUNITY EDUCATION CENTER (CEC)/CURIOUS KIDS/COMMUNITY H.S.

The Community Education Center is located at 1010 West Milham in Portage (corner of Constitution and Milham, Constitution Road dead ends into the parking lot). Follow the parking lot around to the back of the building and use the north entrance.

- Use the north entrance (glass vestibule), located at the back of the building. Proceed down the north hallway to locate classrooms 122-129.

CENTRAL HIGH SCHOOL

Use the student entrance located at the corner of Centre Avenue and Mustang Drive.

- CHS/ Media Center (2nd Floor)–Use the student entrance. Stairs are located to the left. Proceed to the 2nd floor; the Media Center will be in front of you. Elevator is located to the right. Go to the 2nd floor, turn left upon exiting the elevator, proceed over the “bridge” and the Media Center will be on your right.
- CHS/Rm 1130-1136–Use the student entrance and proceed down the hallway past the office to find your classroom.
- CHS/1122 (Art Room) & 1125–Use the student entrance, turn left and proceed through the blue double doors to find your classroom.
- CHS Stable–Located behind Central Middle School on S. Westnedge Avenue, south of Central High School.

- NHS/L114 Follow the sidewalk, located to the right of the 3-story glass entrance, to the door between the two wings of the building. Enter, turn right and proceed to the next hallway.

NORTHERN HIGH SCHOOL/main entrance

- The main entrance is located in front of the high school on Idaho Street.
- NHS/Community Room (Comm Rm) - located down the hall past the office on the right hand side.
- NHS/Commons - located at the bottom of the stairs.

NORTH MIDDLE SCHOOL

- NMS/Pool–Entrance is located on the north side of the school on Idaho Street (facing Northern High School).
- NMS/Media Ctr—Use main entrance, turn left and proceed to the end of the hall. Turn right and continue down hall, the Media Center is on the right.

NORTHERN HIGH SCHOOL/back entrance

Located at the corner of Idaho and Oregon Streets, follow Oregon to the parking lot located at the back of the building

- NHS Commons–Use entrance at the back of the school, lower level. If parking is limited, use the MAIN entrance on Idaho St.
- NHS/Doghouse–Located east of the parking lot.

Room Key

ACT/Activity Area
ART/Art Room
CAF/Cafeteria
COMM RM/Community Room
COMP LAB/Computer Lab
CONF RM/Conference Room
MEDIA CTR/Media Center

Enriched for Life

is printed by Stafford Media

Enrichment Coordinator: Cherie McMullin

GUIDE TO FINDING OUR SCHOOLS/CLASS LOCATIONS

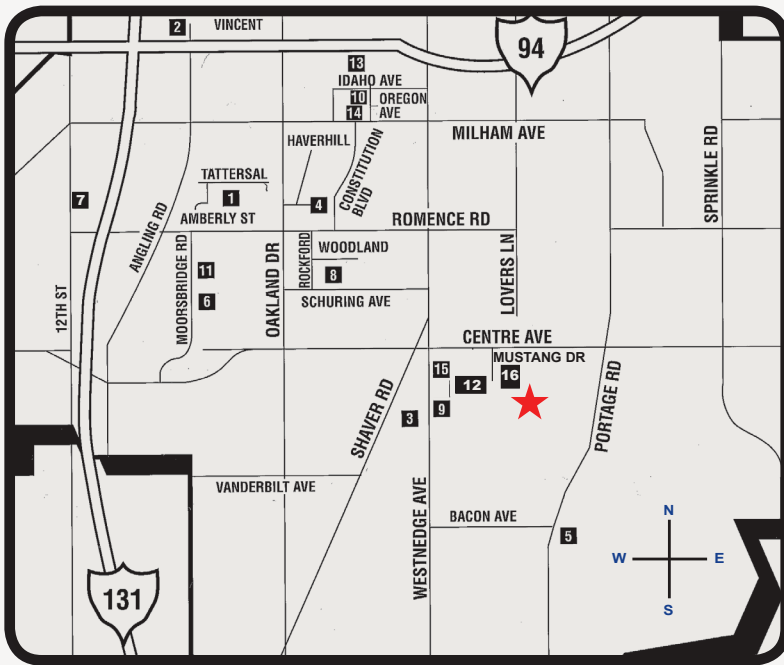

1. **AMB** – Amberly Elementary, 6637 Amberly Avenue
2. **ANG** – Angling Road Elementary, 5340 Angling Road
3. **CEL** – Central Elementary, 8422 South Westnedge Avenue
4. **HAV** – Haverhill Elementary, 6633 Haverhill Avenue
5. **LCE** – Lake Center Elementary, 10010 Portage Road
6. **MBE** – Moorsbridge Elementary, 7361 Moorsbridge Road
7. **TWL** – 12th Street Elementary, 6501 S. 12th Street
8. **WOD** – Woodland Elementary, 1401 Woodland Avenue
9. **CMS** – Central Middle School, 8305 South Westnedge Avenue
10. **NMS** – North Middle School, 5808 Oregon Street
11. **WMS** – West Middle School, 7145 Moorsbridge Road
12. **CHS** – Central High School, 8135 South Westnedge Avenue
13. **NHS** – Northern High School, 1000 Idaho Street
14. **CEC** – Portage Community Education Center, 1010 West Milham Avenue
14. **CEC/CK** – Curious Kids Child Care/Pre-school
14. **CEC/CoHS** – Community High School
16. **ADM** – Administration Building, 8107 Mustang Drive ★
16. **ADM** – Enrichment Office, 8107 Mustang Drive ★

Additional Class Locations

- Fitness Yoga** – 614 Romence Rd. Suite 240
- Great Skate** – 10496 Portage Road
- KIC/Kingdom Sports** – 8151 Merchant Place
- Mosaic Hall & Dance Center** – 10097 Oakland Drive
- West Hills Athletic Club** – 2001 South 11th Street
- Walker's Tae Kwon Do** – 8675 Portage Road



Look for these graphics for ❄️ Winter/ 🌸 Spring classes!